

Gully body Passavant Spin

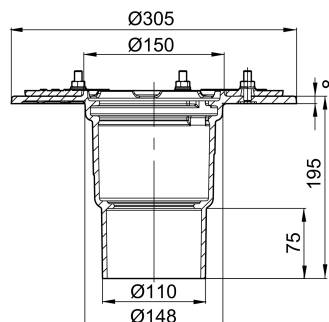

Product information for the product group



Item Technical Data 7034.10.12

Nominal width	Socket inclination	Recess (LxB) [mm]	Weight [kg]
DN 100	90°	160 x 330	6.5

Accessories

	Description	Used with	Weight [kg]	Item number
 <p>Cross-material accessories</p>	Fire protection insert ■ Note: <input type="checkbox"/> The discharge value is reduced by use <input type="checkbox"/> A Fit-in must be installed for core hole drilling <input type="checkbox"/> aBG: Z-19.53-2439 <input type="checkbox"/> abZ: Z-19.17-2430	■ Flat roof gullies Passavant Spin made of cast iron ■ Parking deck gullies Passavant made of cast iron <input type="checkbox"/> DN 100 <input type="checkbox"/> Socket inclination: 90°	0.5	7034.20.02
	Removable dirt trap ■ Made of stainless steel	■ Flat roof gullies Passavant Spin made of cast iron <input type="checkbox"/> DN 70 – DN 100 <input type="checkbox"/> Socket inclination: 90°/0° ■ Parking deck gullies Passavant made of cast iron <input type="checkbox"/> DN 70 – DN 100 ■ Top part made of cast iron <input type="checkbox"/> DN 70/DN 100		7000.03.02

Description		Used with	Weight [kg]	Item number
	Lip seal ring ■ Diameter: 136 mm	■ Jet flat roof gullies □ DN 50 ■ Upper part for Spin flat roof gullies □ DN 70 ■ 1-/2-piece flat roof/terrace Spin gullies DN 70 for ventilation pipe to be added during installation □ SML-pipe DN 100 made from cast iron for grey water down-pipes over roof, length as per DIN EN 12056 and DIN 1986-100	0.1	7047.00.26

You can find further accessories under → <https://www.buildingdrainage.aco/search/?q=7034.10.12>