

SMU S

Short radius bend 22°



DESCRIPTION

Part of the standard range, the SMU S 22° short radius bend allows a change of direction of the fluid waste and rainwater through buildings. The cast iron fittings are coated by cataphoresis and are fully and indefinitely recyclable.

Material & Coatings

- Cast Iron
- Coating: red-brown, anti-corrosive cataphoresis epoxy, average dry film thickness 70 µm.

RECOMMENDED USE

- Rainwater
- Valve water
- Wastewater

TECHNICAL FEATURES

- Hot water resistance: 24h at 95°C.
- Thermal cycle resistance: 1500 cycles between 15°C and 93°C.
- Chemical resistance for $2 \leq \text{pH} \leq 12$.
- Salt spray resistance internal coating: more than 350 h

STANDARDS & APPROVALS

- Industry Product Standards:
 - NF EN877
- Acoustic Performance: $L_{sc} \leq 10 \text{ dB(A)}$ & $L_{aA} = 47 \text{ dB(A)}$ according to EN 14366 with 2L/s.
- Range fire classification: A1

ENVIRONMENTAL DATA

- Percentage of Recycled Content: 99 %
- Recycling Information: Cast iron is 100% recyclable through the existing recycling industrial network. Data source: Environmental Product Declaration S-P-02013



SMU S

Short radius bend 22°

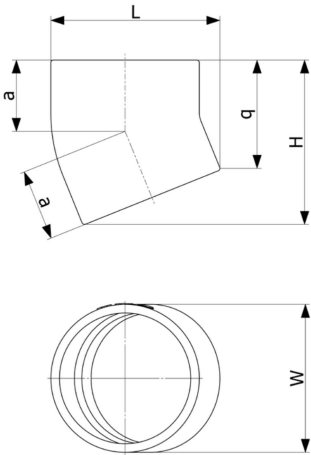

DN	L	H	W	a	q	Weight	Product Code
50	70	88	58	40	66	0.45	156388
75	97	105	83	47	74	0.8	156480
100	126	125	110	54	84	1.3	156598
125	152	143	135	61	92	1.9	156761
150	179	162	160	69	102	2.6	156855
200	233	200	210	83	122	4.4	156974
250	300	240	274	100	138	9.5	157071
300	356	279	326	115	157	15.3	157136
400	466	324	429	142	177	23,7	170730

All dimensions are in mm and nominal weights are in kg

This document is provided for information purposes only and our company reserves the right to modify the information contained herein at any time. Our company declines all responsibility in the event of the use or installation of materials that do not comply with the rules prescribed in this document as well as with the standards, the technical documents and the applicable professional standards. Any orders placed will be subject to our General Terms and Conditions of Sale, available on request. The drawings and/or images are the exclusive property of Saint-Gobain PAM and are confidential. They must not be reproduced or disclosed to any third party without written consent. They may only be used for the purpose for which they were issued and are returnable on request.