

Small water heater, 15 litres, sealed unvented (pressure-tested) Safety assemblies

KV



PIC00004297

KV 307

Safety assembly KV 307 for sealed unvented small oversink water heaters with 10 or 15 litres capacity. Shut-off valve with pressure gauge connection G $\frac{1}{4}$ without pressure reducing valve, plastic drain outlet G 1, brass casing, chrome finish.

- › Safety valve 0.7 MPa (7 bar)
- › Twin connector system for easy installation
- › Rotating safety valve for drip water outlet on the right or left
- › Drain outlet with adjustable drip water inlet
- › DVGW test symbol
- › Test symbol PA-IX...../..

KV 40

Safety assembly to DIN 1988 for sealed unvented wall mounted cylinders up to 200 l capacity. Shut-off valve, pressure gauge connection G $\frac{1}{4}$ with pressure reducing valve, plastic drain outlet G 1, brass body, chrome finish.

- › Safety valve 0.6 MPa (6 bar)
- › Pressure reducing valve, adjustable 0.15 - 0.5 MPa
- › Twin connector system for easy installation
- › Rotating safety valve for drip water outlet on the right or left
- › Drain outlet with adjustable drip water inlet
- › DVGW test symbol
- › Test symbol PA-IX...../..

		KV 307	KV 40
		233482	233481
Max. permissible pressure	MPa	0.56	1.6
Safety valve	MPa	0.7	0.6
Pressure reducing valve		-	X
Pressure reducing valve, nominal pressure			PN 16
Pressure reducing valve setting range	MPa		0.15 - 0.5
Drip water connection		X	X
Type of installation		Unfinished walls	Unfinished walls
Water connection		G 1/2 A	G 1/2 A
Drain outlet		G 1 A	G 1 A

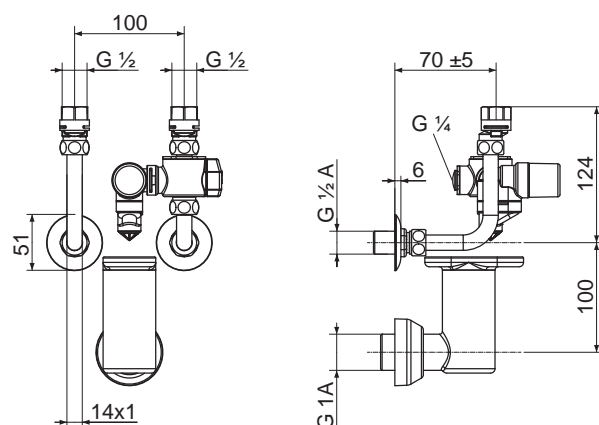

D0000040449

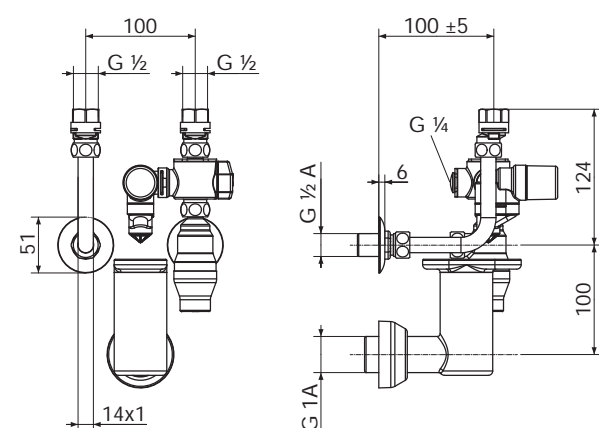

D0000040332