

ISO PIPE FITTING

T-piece



Design feature

- With internal thread according to ISO 228

Order No.	Ø Pipe	Thread	MOP (PN)	L	E	Weight
6501	32	1"	16	195	80	1,50
	40	1¼"		228	93	2,40
	50	1½"		235	93	2,70
	63	2"		273	105	4,10

If using as sleeve - Attention: no stop

Design feature

- With internal thread according to ISO 228

Order No.	Ø Pipe	Thread	MOP (PN)	L	E	Weight
6500	20	½"	16	114	48	0,38
	25	¾"		134	58	0,56
	32	1"		162	70	0,83
	40	1¼"		199	84	1,45
	50	1½"		239	101	2,20
	63	2"		245	114	3,90

Order No.	Ø Pipe	Thread	MOP (PN)	L	E	Weight
6520	20	½"	16	110	48	0,10
	25	¾"		134	58	0,13
	32	1"		163	70	0,24
	40	1¼"		193	82	0,43
	50	1½"		235	99	0,60
	63	2"		267	110	0,90

Order No.	Ø Pipe	Thread	MOP (PN)	L	E	Weight
6510	50	2"	16	240	101	2,40
	75	1"		258	99	5,20
	75	2"		258	99	4,75

Order No.	Ø Pipe	MOP (PN)	L	E	Weight
6530	32	16	176	70	1,00
	40		214	84	2,20
	50		250	101	3,20
	63		300	114	4,80

Order No.	Ø Pipe	MOP (PN)	L	E	Weight
6550	25	16	144	58	0,16
	32		179	70	0,25
	40		216	82	0,57
	50		248	99	0,75
	63		297	110	1,20

Order No.	Ø Pipe 1	Ø Pipe 2	MOP (PN)	L	E	E1	Weight
6531	32	25	16	157	70	58	0,90
	40	25		185	84	58	1,50
	50	25		218	101	58	2,00
	50	32		227	89	70	2,00
	50	40		240	89	84	2,60
	63	32		251	114	70	2,70
	63	40		262	114	84	3,20
	63	50		275	114	99	3,50

T-piece

With internal thread outlet, with detachable ends for subsequent assembly

No. 6501

Made of ductile iron

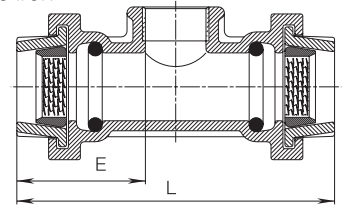

T-piece

With threaded outlet

No. 6500

Made of ductile iron

No. 6520

Made of POM

Internal thread reduced

No. 6510

Made of ductile iron

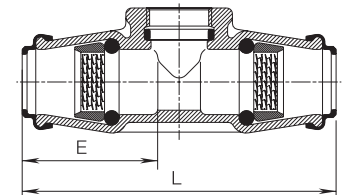

T-piece

With 3 sockets

No. 6530

Made of ductile iron

No. 6550

Made of POM

T-piece reduced

No. 6531

Made of ductile iron

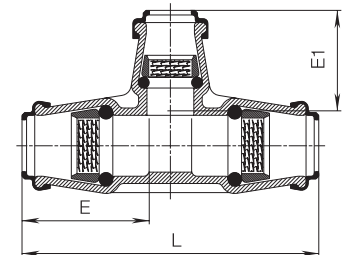

E. Hawle Armaturenwerke GmbH 4840 Vöcklabruck - Austria - Wagrainstraße 13
Tel.: +43 (0) 7672 72576 0 - Fax: +43 (0) 7672 78464 - E-Mail: hawle@hawle.at - www.hawle.com

K 6/1